

Recording at the Creek

April 5-6, 2013

Friday

7:30 a.m. – 8:45 a.m.	Breakfast (Cafeteria, provided for those who stayed Thursday evening) Phil Barfoot will be doing a round table discussion specifically for ministers of music during this time. Anyone is invited to attend but only those paying for Thursday are included in the count for the breakfast.
9:15 a.m.	Rehearsal (Tabernacle)
11:45 a.m.	Lunch
1:15 p.m.	Rehearsal (Tabernacle)
3:00 p.m.	Break and snacks (Please bring a snack to share)
3:30 p.m. – 4:30 p.m.	Rehearsal (Tabernacle)
4:30 p.m.	Break for Dinner
6:00 p.m. – 10:00 p.m.	Recording with break (Tabernacle)
10:00 p.m.	Free Time
11:00 p.m.	Lights out in cabin sleeping areas

Saturday

7:00 a.m. – 8:45 a.m.	Breakfast (Make sure everything is out of your cabin or hotel room before you head to rehearsal.)
8:50 a.m.	Group picture (Gather on stage in the Tabernacle, CONCERT ATTIRE)
9:00 a.m. – 1:00 p.m. (to 1 p.m. or until done)	Recording with breaks (Please bring a snack to share.)
12:30 or 1:00 p.m.	Lunch for Soloists and Tech Crew (25 lunches provided)
1:30 p.m.	Mercy (2 solos)
2:15 p.m.	The Applause of Heaven
3:15 p.m.	Oh Happy Day (2 solos)
4:15 p.m.	Song of Moses
5:15 p.m.	The Same Love (2 solos)
6:15 p.m.	Dinner (for remaining solos and tech crew.)
7:00 p.m.	In Times Like These (2 solos)

What to Bring

1. **Everyone must have an FM receiver and earbuds or headphones.** All sound will be played through the headphones so this is very important. **BRING EXTRA BATTERIES.**
2. Comfortable clothing. **CONCERT ATTIRE** and shoes.
3. Music downloaded from website.
4. Sheet/sleeping bag, pillow, toiletries. You will want to bring a towel.
5. Snacks to share on Friday and Saturday – pot luck style.
6. Extra money for soda machine in cafeteria. We will be providing water and coffee during the snack times.

Group lodging is as follows:

- Men (Durant, First), Women (Ada, First)
- For those arriving on Thursday staying in the group lodging, please arrive no earlier than 4 p.m.
- Those coming in Thursday with a hotel room can check in at the Falls Creek office. After the office closes (6:00 p.m.) hotel keys will be in your rooms. We will email out a rooming list on Monday for the HOTEL room. Group lodging is in the 2 main cabins (Durant, First – men and Ada, First for the women). Attached is a map of Falls Creek.

Directions

Falls Creek Conference Center is just outside of Davis, Oklahoma, off interstate highway 35, exit number 51. Highway and regional signs will direct you to the Falls Creek Baptist Conference Center after you exit I-35.

Physical Address:
6714 HWY 77D
Davis, OK 73030-8002

Low Road

Take Exit 51. Turn left and cross over Interstate 35. Turn right on the first road you come to just past Interstate 35 which is Kay Starr Trail. Stay on Kay Starr for about 3 miles, going straight through the intersection following the signs for Arbuckle Wilderness. When you come to Price Falls you will see a large red sign that says "Falls Creek." Turn right and continue through Price Falls crossing the low water crossing at the creek and going up the hill. You will see the front gate of Falls Creek on your left.

From Dallas / I-35 northbound

Low Road

Take Exit 51. Turn right and take the first immediate road to the right which is Kay Starr Trail. Stay on Kay Starr for about 3 miles, going straight through the intersection following the signs for Arbuckle Wilderness. When you come to Price Falls you will see a large red sign that says "Falls Creek." Turn right and continue through Price Falls crossing the low water crossing at the creek, and going up the hill. You will see the front gate of Falls Creek on your left.

From Davis

Low Road

Take Hwy 7 west until you come to the Pizza Hut. Turn left onto Hwy 77. Just before you get to Interstate 35, turn left on Kay Starr Trail. Stay on Kay Starr for about 3 miles, going straight through the intersection following the signs for Arbuckle Wilderness. When you come to Price Falls you will see a large red sign that says "Falls Creek." Turn right and continue through Price Falls crossing the low water crossing at the creek, and going up the hill. You will see the front gate of Falls Creek on your left.

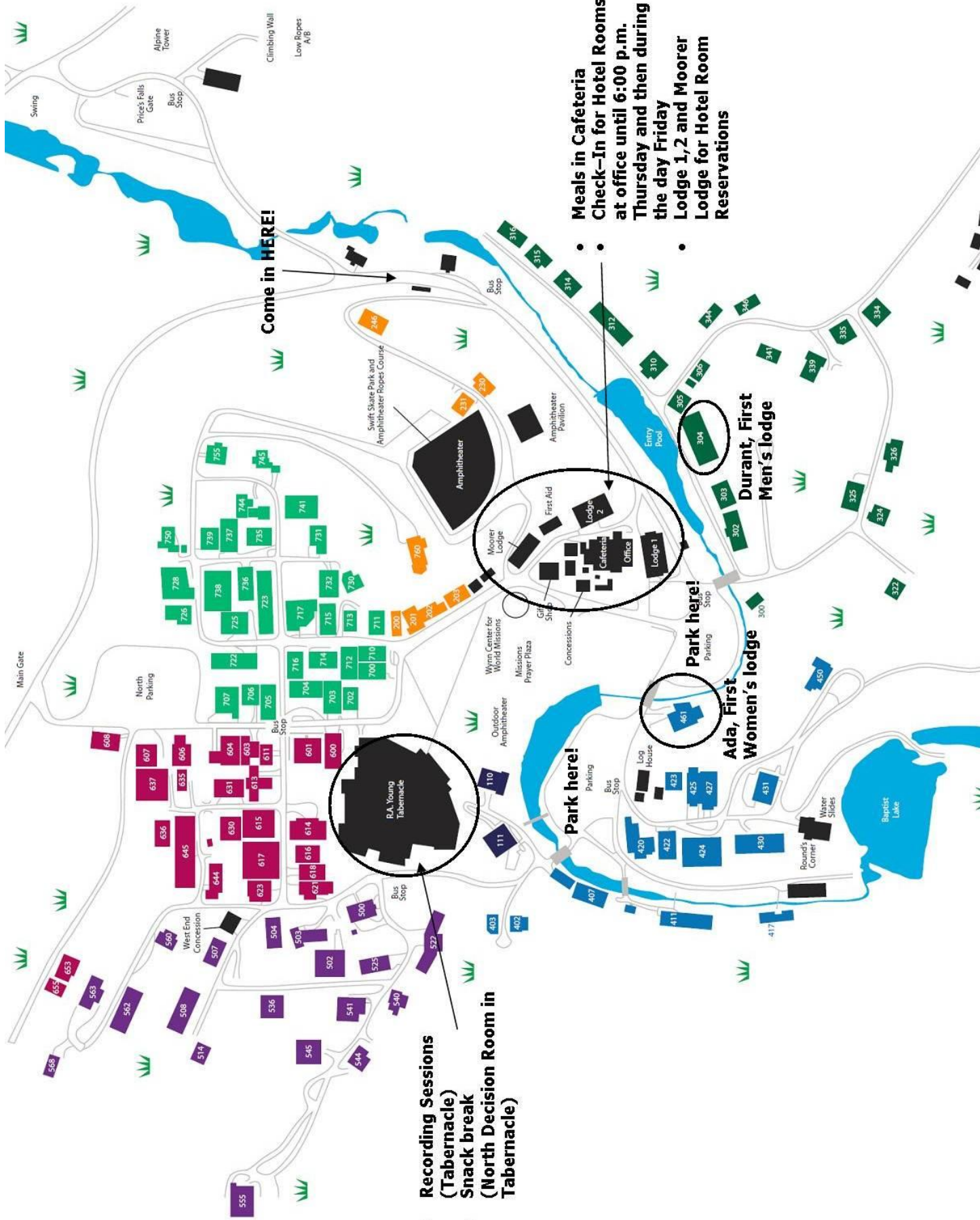

- **Recording Sessions (Tabernacle)**
- **Snack break (North Decision Room in Tabernacle)**

- **Meals in Cafeteria**
- **Check-In for Hotel Rooms at office until 6:00 p.m. Thursday and then during the day Friday**
- **Lodge 1,2 and Moorer Lodge for Hotel Room Reservations**

Come in HERE!

Park here!

Park here!

Park here!

Durant, First Men's lodge

Ada, First Women's lodge

P.A. Young Tabernacle

Moorer Lodge

Lodge 2

Cafeteria

Office

Lodge 1

First Aid

Amphitheater

Amphitheater Pavilion

Entry Pool

Amphitheater

Wynn Center for World Missions

Missions Prayer Plaza

Concessions

Outdoor Amphitheater

Log House

Water Slides

Round's Corner

Round's Corner

Round's Corner

Round's Corner

Round's Corner